

SWAB COLLECTION INSTRUCTIONS

IMPORTANT

Please wait at least 30 minutes after a meal or treat (drinking water is fine) to begin your DNA collection. Before collecting the sample, inspect your animal's mouth between cheek and gums for any food material. If collecting from a kitten/puppy that is weaning, please remove from mother for approximately 20 minutes before swabbing. Sample one animal at a time – complete the process for one animal before moving to the next animal.

Please Note: If samples are collected on cotton swabs a \$10 handling fee will be charged.

- OPEN SWAB SLEEVE** – Peel back the edges of the nylon brush packaging. Try not to tear the sleeve as it is required for later use. Peel (open) from the handle end and remove the swabs by holding the handle. Remove the unique barcode strip which contains 3 stickers from the packet.
- COLLECT DNA (EPITHELIAL CELLS)** – Place the bristle (nylon) head against the inside of the cheek. Pinch the cheek around the bristle head and firmly roll the swab around the pinched area. Pinch and swirl for about 15 seconds. Repeat this step with the second swab.
- DRY THE SWABS** – Allow the swabs to air dry for 3-5 minutes. This can be done by standing them up.
- REINSERT DRY SWABS** – After the swabs have dried, place them both into the original packaging. Seal the packet closed with one of the barcode stickers.
- COMPLETE DETAILS** – Complete the details on the back of the swab packaging, and place another barcode sticker on the space allocated on the packet. Complete the molecular DNA form to ensure all details are included, and place the final barcode sticker on the space allocated on the form.
- MAIL TO TEST LAB** – Post samples back to:
Orivet Genetic Pet Care
PO BOX 110 St KILDA 3182 VIC AUSTRALIA.
- OVERSEAS CLIENTS** – Please write our AQIS Permit Number IP 13017917 – Canine DNA Swab Samples Enclosed (Non Pathogenic Samples) on the front of envelope.
- SAMPLE ARRIVAL** – Samples can be posted via normal post to the PO BOX and are stable at room temperature. You will receive an email to notify you when your samples arrive.

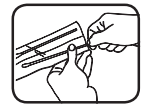
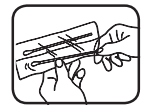

www.orivet.com.au

Phone: +61 3 9534 1544

Email: info@orivet.com.au

